

SPRINGS

CHART 1A: POUNDS PER INCH SPRINGS - ROUND WIRE

WIRE SIZE	INSIDE COIL DIAMETERS					
	1 3/4	2	2 5/8	3 3/4	5 1/4	6
.225	.310					
.250	.349	.393	.502			
.262	.369	.415	.530	.736		
.283	.402	.451	.575	.797		
.295	.427	.479	.610	.844		
.312			.641	.887	1.214	1.378
.331			.683	.943	1.290	1.463
.343				.983	1.343	1.523
.362				1.041	1.421	1.611
.375				1.080	1.473	1.670
.395						1.758
.406				1.179	1.605	1.818
.437				1.279	1.737	1.967

CHART 1B: POUNDS PER INCH SPRINGS - SQUARE WIRE

WIRE SIZE		INSIDE COIL DIAMETERS						
Fract.	Dec.	2 3/16	2 3/4	3 1/8	3 5/8	4	5 1/4	5 7/8
1/4	.250	.90*						
9/32	.281	.90*						
5/16	.312	.90*	.93	.96	1.10		1.55	
11/32	.343	.75	.94	1.05	1.22		1.74	
3/8	.375		1.03	1.15	1.33		1.89	
13/32	.406		1.14	1.27	1.48		2.05	
7/16	.437		1.20		1.59	1.73	2.23	2.68

* FOR PRICING ONLY

DRAWING 1: WIND

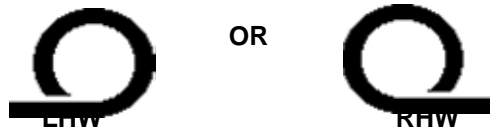

ORDERING INFORMATION

WIRE SIZE measure 20 coils to the nearest 1/16",
divide by 20

DIAMETER measure inside of spring to the nearest 1/16"

LENGTH measure the total length of the spring at
rest (not under tension)

WIND refer to Drawing 1 (LHW or RHW)

SPRING PLUGS

 PART NO.	DESCRIPTION INSTALLATION INCLUDED ALSO AVAILABLE LOOSE	UNIT
P175	1 3/4" Aluminum, universal	Pair
P200	2" Aluminum, universal	Pair
P2625	2 5/8" Aluminum, universal	Pair
P3625S	3 5/8" Steel welded for square or round 1" or 1 1/4" bore	Pair
P375	3 3/4" Plugs, universal	Pair
P525S	5 1/4" Steel welded for square or round 1" or 1 1/4" bore	Pair
P525	5 1/4" Aluminum 1" or 1 1/4" bore, universal	Pair
P600	6" Aluminum 1" or 1 1/4" bore, universal	Pair
P600C	6" Cast iron 1" or 1 1/4" bore	Pair



P175/P200, P2625 & P375:

- ▶ Universal Thread
- ▶ Max wire 0.295"
- ▶ Max wire 0.331" - P2625
- ▶ Max wire 0.406" - P375



P525, P600 & 600C:

- ▶ Universal Thread
- ▶ Max wire 0.437"
- ▶ Max wire 0.437" - P600 & 600C

SPRING FAILURE DEVICE

<div style="border: 1px solid black; padding: 2px; display: inline-block;">P/N</div> PART NO.	DESCRIPTION	UNIT
SFSD	1" Shaft, up to 6" springs	Each
SFSD125	1 1/4" Shaft, up to 6" springs	Each
SFSDB	Extension bracket for above SFSD & SFSD125	Each



SFSD:

- ▶ 1" Shaft up to 6" springs
- ▶ Not meant for duplex spring assembly
- ▶ Max torque on counter balancing shaft: 155 ft/lbs

SFSDB:

- ▶ Will fit offsets of: 4 3/8", 5" & 6"

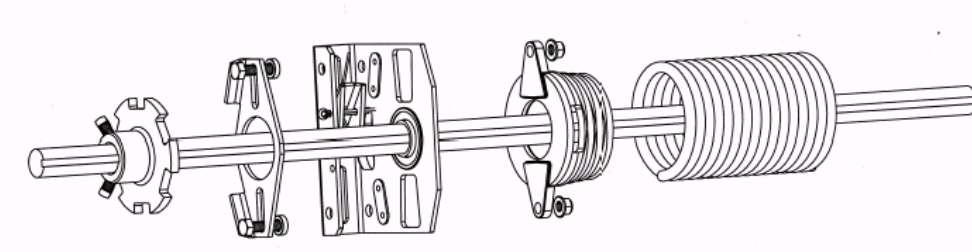

SPRING BUSHINGS

<div style="border: 1px solid black; padding: 2px; display: inline-block;">P/N</div> PART NO.	DESCRIPTION	UNIT
WC	16' Length or cut to size	Foot

WC:

- ▶ PVC bore for 1" or 1 1/4" shaft